

Space Plan High Density Layout

For indicative purposes only, subject to an occupier making their own configurations

- 1 Reception
- 2 12-Person Boardroom
- 1 5-Person Meeting Room
- 2 Office
- 1 Communication Room
- 2 Copy Area
- 1 Teapoint
- 4 Staff Breakout/Informal Meetings
- 96 Open-Plan Work Stations

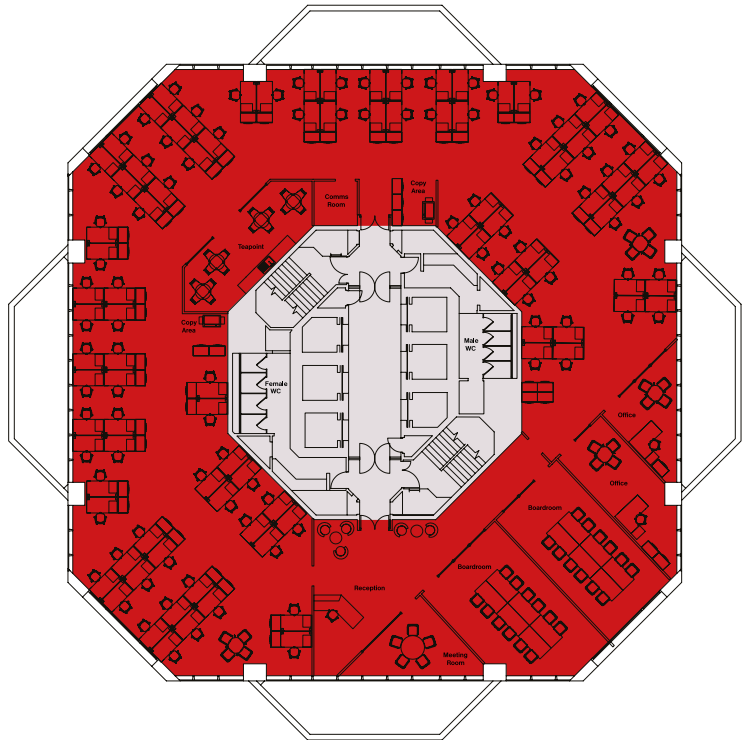

Space Plan Low Density Layout

For indicative purposes only, subject to an occupier making their own configurations

- 1 Reception
- 1 12-Person Boardroom
- 2 5-Person Meeting Room
- 2 Office
- 1 Communication Room
- 2 Copy Area
- 1 Teapoint
- 4 Staff Breakout/Informal Meetings
- 80 Open-Plan Work Stations

